

LX MOP2

Means of propulsion sensor 2

Installation manual

Version 2.0



1	Important Notices	3
1.1	Limited Warranty	3
2	Packing list	4
3	Fitting MOP2	5
4	Functional test	7
5	Analysing MOP2 record	9
6	Technical	10
7	Revision history	11

1 Important Notices

Information in this document is subject to change without notice. LXNAV reserves the right to change or improve their products and to make changes in the content of this material without obligation to notify any person or organisation of such changes or improvements



A Yellow triangle shows parts of the manual which should be read very carefully and are important for operating the system.



Notes with a red triangle describe procedures which are critical and may result in loss of data or any other critical situation.



A bulb icon shows when a useful hint is provided to the reader.

1.1 Limited Warranty

This LX MOP2 product is warranted to be free from defects in materials or workmanship for two years from the date of purchase. Within this period, LXNAV will, at its sole option, repair or replace any components that fail in normal use. Such repairs or replacement will be made at no charge to the customer for parts and labour, provided that the customer shall be responsible for any transportation cost. This warranty does not cover failures due to abuse, misuse, accident, or unauthorised alterations or repairs.

THE WARRANTIES AND REMEDIES CONTAINED HEREIN ARE EXCLUSIVE AND IN LIEU OF ALL OTHER WARRANTIES EXPRESSED OR IMPLIED OR STATUTORY, INCLUDING ANY LIABILITY ARISING UNDER ANY WARRANTY OF MERCHANTABILITY OR FITNESS FOR A PARTICULAR PURPOSE, STATUTORY OR OTHERWISE. THIS WARRANTY GIVES YOU SPECIFIC LEGAL RIGHTS, WHICH MAY VARY FROM STATE TO STATE.

IN NO EVENT SHALL LXNAV BE LIABLE FOR ANY INCIDENTAL, SPECIAL, INDIRECT OR CONSEQUENTIAL DAMAGES, WHETHER RESULTING FROM THE USE, MISUSE, OR INABILITY TO USE THIS PRODUCT OR FROM DEFECTS IN THE PRODUCT. Some states do not allow the exclusion of incidental or consequential damages, so the above limitations may not apply to you. LXNAV retains the exclusive right to repair or replace the unit or software, or to offer a full refund of the purchase price, at its sole discretion. SUCH REMEDY SHALL BE YOUR SOLE AND EXCLUSIVE REMEDY FOR ANY BREACH OF WARRANTY.

To obtain warranty service, contact your local LXNAV dealer or contact LXNAV directly.

2 Packing list

- MOP2 BOX with attached Hall current sensor
- 3.5m RS485 extension cable (Male/Female)
- Installation manual



3 Fitting MOP2

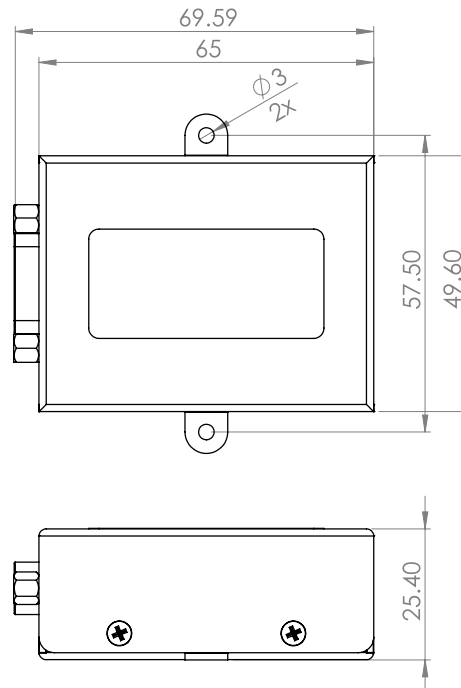

Figure 1: MOP2 dimensions

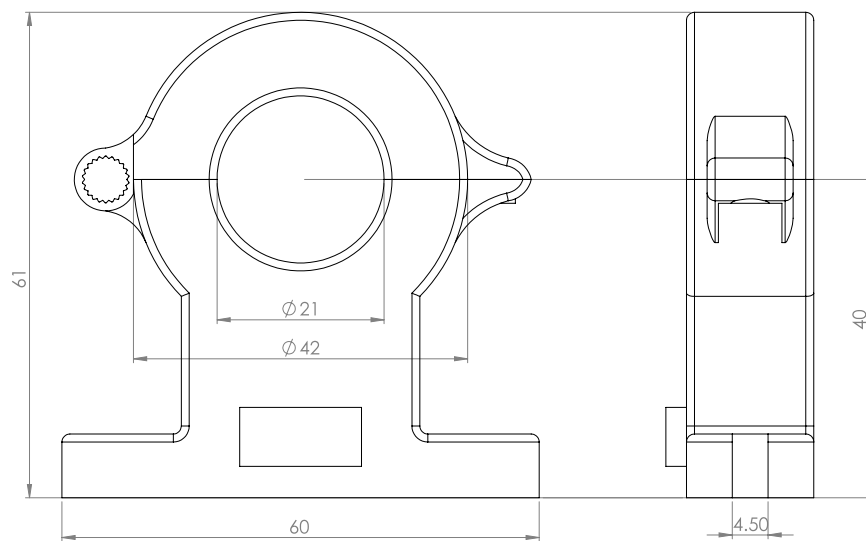

Figure 2: Hall current sensor dimensions

- Install MOP2 and Hall current sensor close to the positive lead of battery of the E-motor (refer to Figure 1 and Figure 2 for detailed dimensions)
- Unscrew the screw holding the hall current sensor frame closed and then open it
- Place the positive lead cable from the battery through the open hall current sensor (refer to Figure 3 for positive current flow), close the frame and screw it back
- If the cable going through the sensor is not fixed entirely (too small diameter) we recommend padding the section of the cable that goes through the sensor before final fixing. If the cable is not fixed, there will be errors in measurements!

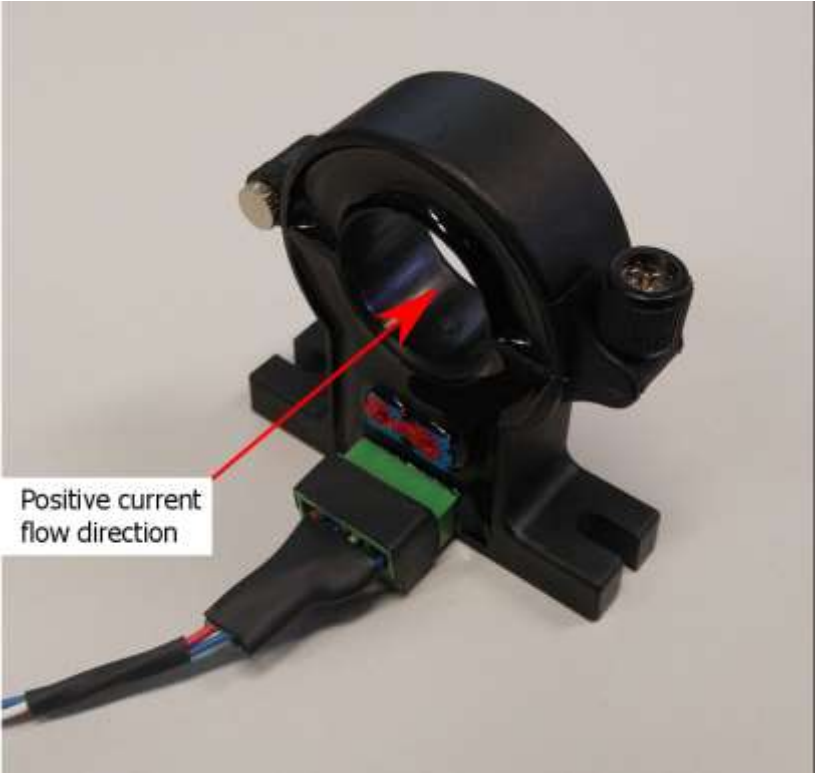

Figure 3: Hall sensor - positive current flow direction

4 Functional test

Functional test can be performed on the LXxxxx system by 2 procedures.

MOP2 Setup - option:

1. Switch on LXxxxx device and a FCU unit
2. On the LXxxxx device, go to Setup->Password menu
3. Insert password 09978



Do not enter into password 09978, when engine is running. After entering into this menu, first MOP sensor is aligned to zero. If engine is running, you will have false indication of the current.

4. Add power on FES
5. Check Current on LX9000 and FCU unit (it should be equal).

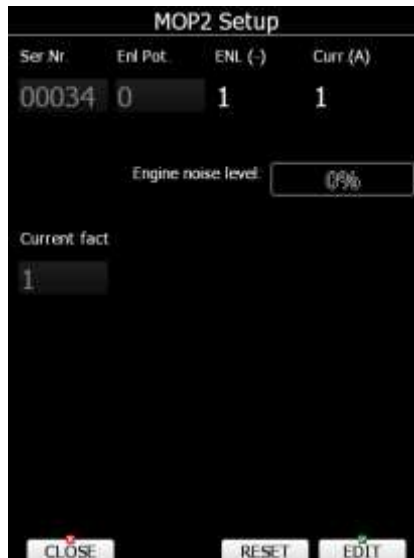

ENGINE NOISE LEVEL option:

On the LXxxxx go to SETUP->HARDWARE->ENGINE.

1. Add power on FES
2. Check MOP level percentage bar (it should be equal to FCU unit; 100% = 100 Amp current).

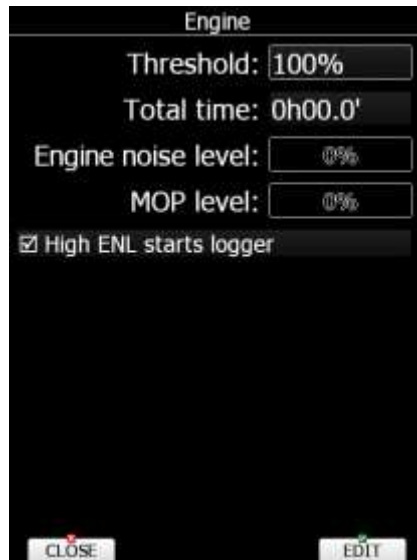

5 Analysing MOP2 record

Mop record is stored in IGC file as additional column, called MOP. Mop values are normally moving between 0 and 999.

6 Technical

Property	Value	Note
MOP2 Current consumption	70mA	At 12V
MOP2 Input voltage range	9-18V	
Hall current range	+/- 300A	

7 Revision history

March 2018	Complete revision of this manual
October 2022	Updated ch.4